

## Materialdatenblatt Material Data Sheet

## STO



Vorderansicht Front elevation

## Frontansicht Front elevation

- (1) StoVentec  
Oberfläche: Putz StoMiral K 6,0 + Struktur-Walze + Schablone (Kreis), Farbton: Sto AC 16000  
StoVentec  
Surface: Plaster StoMiral K 6,0 + Structural roller + pattern (circle), color: Sto AC 16000
- (2) Naturstein Sto-Fossil SBL, gestanzt  
ca. 400 x 100 x 20-30 mm, Fugenbreite: 8 mm  
Natural stone Sto-Fossil SBL, pressed approx. 400 x 100 x 20-30 mm, joint width: 8 mm
- (3) StoVentec  
Oberfläche: Glasfliesen Stolit Effect, getönt mit Effect Vetro, Farbton: Sto AC 37131  
StoVentec  
Surface: Glass tiles Stolit Effect, tinted with Effect Vetro color: Sto AC 37131
- (4) WDVS, Oberfläche: Stolit K 1,5, Farbton: Sto AC 16000  
ETICS, Surface: Stolit K 1,5, color: Sto AC 16000



Rückansicht Rear elevation

## Rückansicht Rear elevation

- (4) WDVS, Oberfläche: Stolit K 1,5, Farbton: Sto AC 16000  
ETICS, Surface: Stolit K 1,5, color: Sto AC 16000
- (5) Steinpaneel, Sto-Fossil SBL, poliert  
Stone panel, Sto-Fossil SBL, polished
- (6) Steinpaneel, Sto-Fossil SKL, grob gestockt  
Stone panel, Sto-Fossil SKL, coarse bush-hammered
- (7) Glaspaneel, Farbton: ähnlich RAL 9005  
Glass panel, Colour: similar to RAL 9005
- (8) Steinpaneel, Sto-Fossil SKL, geschliffen C320  
Stone panel, Sto-Fossil SBL, ground C320
- (9) Glaspaneel, Farbton: ähnlich RAL 5020  
Glass panel, Colour: similar to RAL 5020
- (10) Steinpaneel, Sto-Fossil SKL, maschinenscharriert  
Stone panel, Sto-Fossil SKL, machine-chiselled
- (11) Steinpaneel, Sto-Fossil SKL, poliert  
Stone panel, Sto-Fossil SKL, polished

**Materialdatenblatt Material Data Sheet STO**



Detail Unterkonstruktion Substructure detail

**Befestigung Fixing**

- (13) Horizontale Aluminium /Aluminium-Unterkonstruktion  
Horizontal aluminium /aluminium substructure

**Ebenen Layers**

- (14) StoVentec Fassade,  
Vorgehängtes hinterlüftetes Fassadensystem  
StoVentec facade,  
Rear ventilated facade system

<b>Aufbau:</b>	<b>Structure:</b>
Dämmung	Insulation
Unterkonstruktion	Substructure
StoVentec Trägerplatte	StoVentec carrier plate
Putzgrund	Plaster base
Unterputz	Plaster undercoat
Gewebe	Fabric
Klebemörtel	Adhesive mortar
Naturstein	Natural stone

- (15) StoTherm Mineral WDVS Fassade

StoTherm Minearl ETICS facade

<b>Aufbau:</b>	<b>Structure:</b>
Verklebung	Adhesion
Dämmung	Insulation
Unterputz	Plaster undercoat
Gewebe	Fabric
Zwischenanstrich	Intermediate coating
Oberputz/Anstrich	Coating or paint

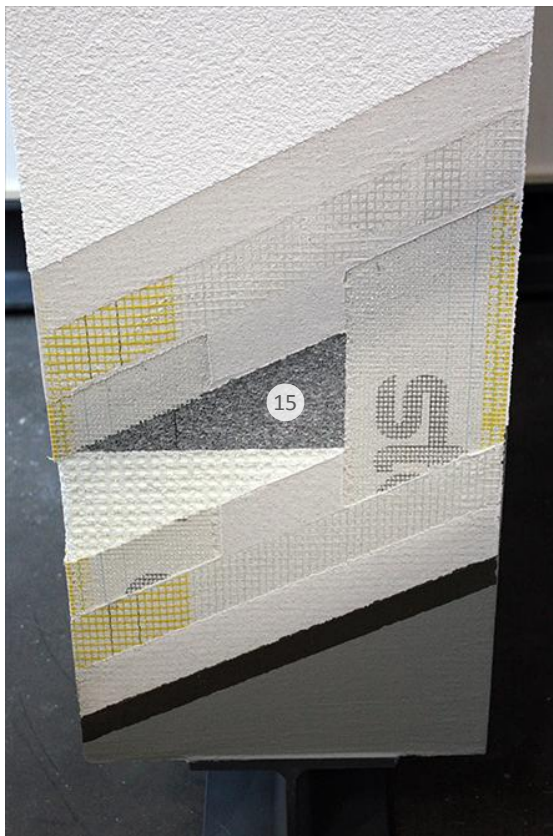

Detail der WDVS-Ebenen Layer detailing of ETICS